

GN 115-NI

Latches

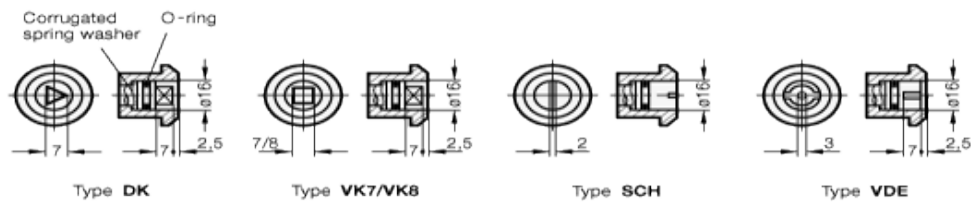

INOX
Stainless Steel

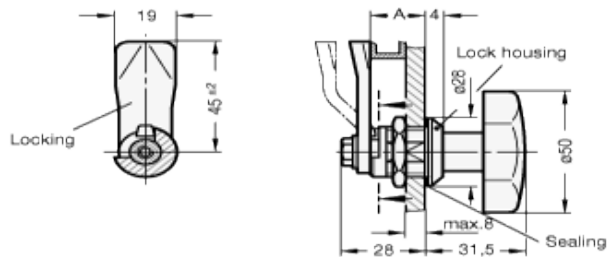

technical informations

Material

AISI 303 stainless steel NI.

Standard versions available

- Type DK: Operation with triangular spindle.
- Type VK7: Operation with square spindle A/F7.
- Type VK8: Operation with square spindle A/F8.
- Type SCH: Operation with slot.
- Type VDE: Operation with double bit.
- Type SG: Operation with AISI 304 stainless steel lobe knob, type GN 5334.

Accessories on request

- Key GN 119.2.
- Protective caps GN 120.
- Opening handles GN 320.

Assembly instructions

Stainless Steel-Latches GN 115 lock by a turning operation limited to 90° which moves the locking behind the door frame. The bevels of the locking ease the closing of the door.

Latches with different cranks cover a range A from 6 to 28 mm.

The operating bolt is fitted with an O-ring for sealing.

Stainless Steel-Latches GN 115 are supplied with loosely enclosed locking.

Features and applications

Latches GN 115-NI are low cost.

They offer a straightforward locking action rather than a locking and clamping action.

The choice of 9 differently shaped catch plates gives a range A of 6 to 28 mm.

Technical and assembly instructions

By turning the latch by max. 90°, the locking is moved behind the frame preventing the opening of the door or shutter. The latch is slightly included towards the outside.

The sketch on the left shows the hole required through which the latch is installed.

The mechanism is inserted through the hole from the front and the hexagon nut can be fitted from the back.

In serial production the **mounting hole** for the door is done by punching or lasing.

For small batch series and sheet metal up to 2 mm thickness the sheet metal punch GN 123 is suitable → Page XYZ.

Furthermore the mounting hole can be realised by drilling / milling according to the sketch on the left.

Standard Elements	Main dimension	Weight
Description	A	g#
GN 115- *-6-NI	6	80
GN 115- *-10-NI	10	130
GN 115- *-14-NI	14	130
GN 115- *-18-NI	18	130
GN 115- *-20-NI	20	130
GN 115- *-22-NI	22	130
GN 115- *-24-NI	24	130
GN 115- *-26-NI	26	130
GN 115- *-28-NI	28	130

*Complete the description of the standard item needed by adding SG (with star knob), DK (with triangular spindle), VK7 (with square spindle), VK8 (with square spindle) or VDE (with double bit).# Weight type SG.



STANDARD MACHINE ELEMENTS WORLDWIDE